

Manga Profile Step-by-Step Guide

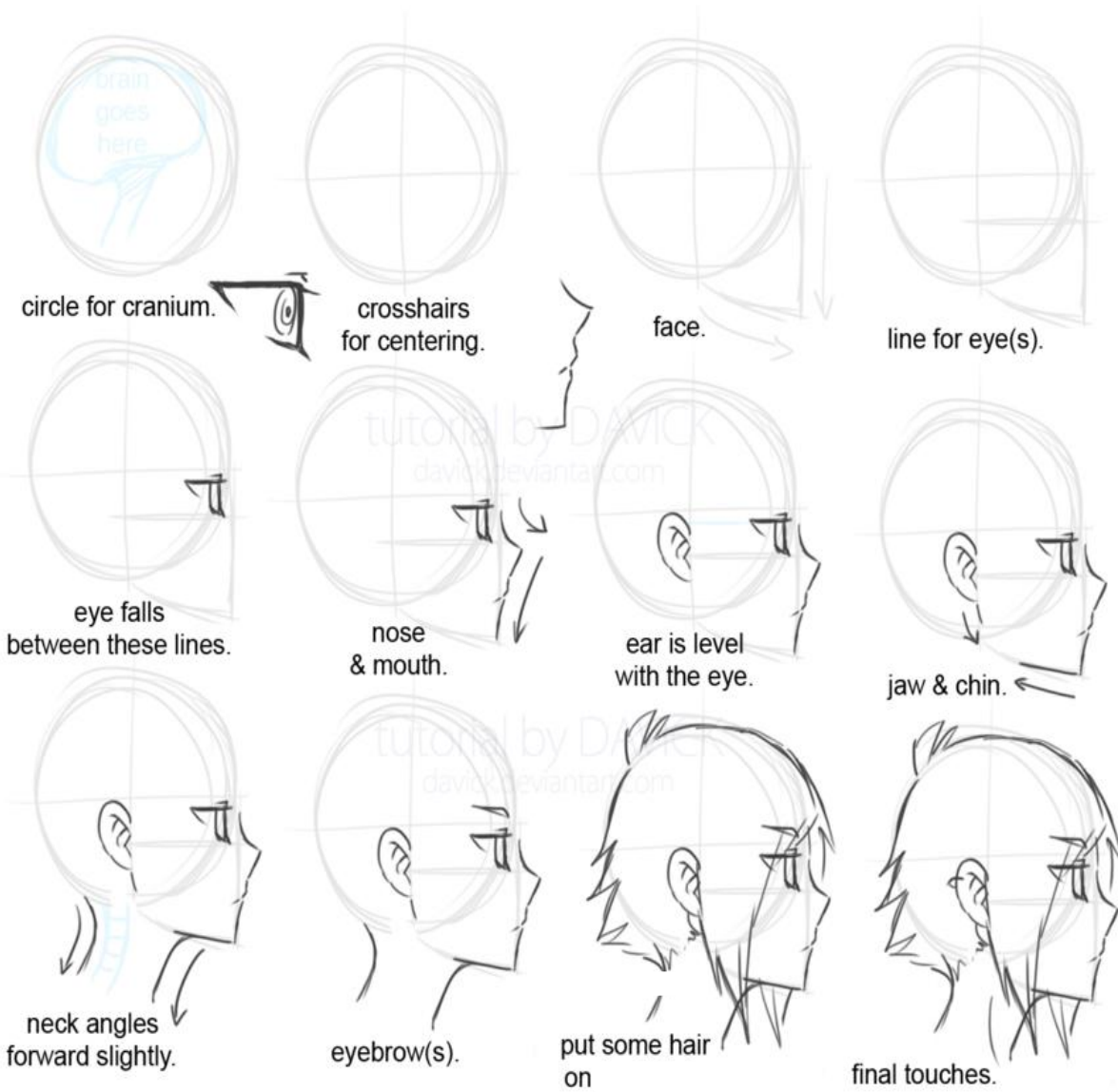

Basics - How to draw the female head

Step by step instructions for drawing the female head
 LearnManga Lesson by Nashi naschi.deviantart.com

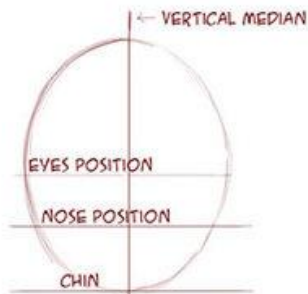

DRAW AN ELYPSE AND DRAW A CROSS IN THE CENTER OF IT.

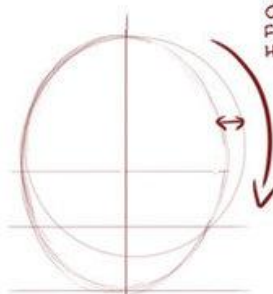

THE HEAD IN SIDE-VIEW IS WIDER THAN THE HEAD IN FRONT-VIEW.

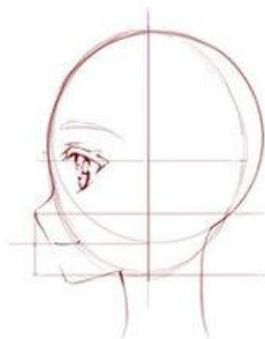
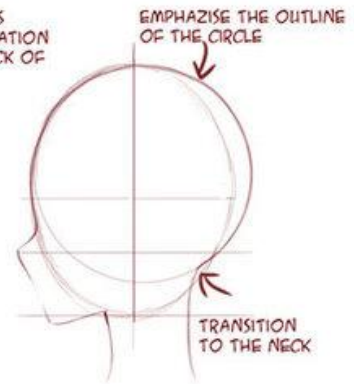

IN FRONT VIEW THE MOUTH IS ALSO DRAWN IN THE CENTER BETWEEN NOSE AND CHIN.

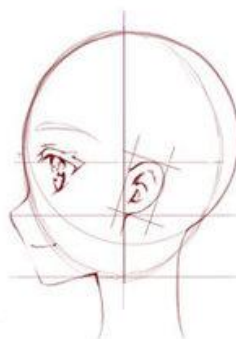

THE EAR IS SLIGHTLY BENT AND IS DRAWN BETWEEN THE NOSE AND EYES



PAY ATTENTION ON THE VOLUME OF THE HAIR AND DRAW THE PONY ALONG THE ROUND SHAPE OF HER HEAD.